

For more detailed installation instructions visit [www.diodeled.com](http://www.diodeled.com).

|                 |                     |                   |                  |
|-----------------|---------------------|-------------------|------------------|
| <b>Max. Amp</b> | 12V - 5A / 24V - 4A | <b>Wire Gauge</b> | 14 AWG - 20 AWG* |
|-----------------|---------------------|-------------------|------------------|

\*Stranded, not tinned wire only. If utilizing 14AWG solid or tinned wire, replace stock screws with included alternates.

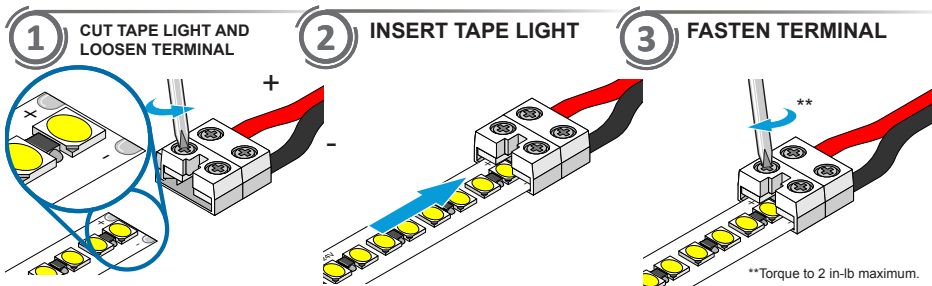

Toll Free: 877.817.6028 | Fax: 415.592.1596 | [www.DiodelLED.com](http://www.DiodelLED.com) | [info@DiodelLED.com](mailto:info@DiodelLED.com)

© 2019 Elemental LED Inc. All rights reserved. Specifications are subject to change without notice.